

Suitable for air, water, oil, steam, etc.

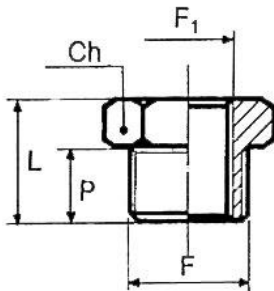

251.02/N

## Reducing nipple

Art. No.	Type No.	Male thread F	Female thread F1	Ch mm	P mm	L mm
111330	251.00/N	G 1/8	M5	14	6.0	10.5
111331	251.01/N	G 1/4	G 1/8	17	8.0	13.0
111331 = discontinued product. No longer available. New product 134710 (MSN251K1418)						
111332	251.06/N	G 3/8	G 1/8	20	9.0	14.0
111332 = discontinued product. No longer available. New product 134711 (MSN251K3818)						
101040	251.02/N	G 3/8	G 1/4	20	9.0	14.0
101040 = discontinued product. No longer available. New product 134712 (MSN251K3814)						
111333	251.08/N	G 1/2	G 1/8	24	10.0	15.5
111333 = discontinued product. No longer available. New product 134713 (MSN251K1218)						
111334	251.07/N	G 1/2	G 1/4	25	10.0	15.5
111334 = discontinued product. No longer available. New product 134714 (MSN251K1214)						
111335	251.03/N	G 1/2	G 3/8	25	10.0	15.5
111335 = discontinued product. No longer available. New product 134715 (MSN251K1238)						
111336	251.09/N	G 3/4	G 3/8	30	11.0	17.5
111336 = discontinued product. No longer available. New product 134717 (MSN251K3438)						
111337	251.10/N	G 3/4	G 1/2	30	11.0	17.5
111337 = discontinued product. No longer available. New product 134718 (MSN251K3412)						
111338	251.11/N	G 1	G 1/2	36	12.0	19.0
111338 = discontinued product. No longer available. New product 134719 (MSN251K0112)						
111339	251.12/N	G 1	G 3/4	36	11.5	19.0
111339 = discontinued product. No longer available. New product 134720 (MSN251K0134)						

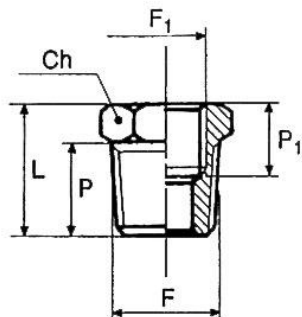

235.04/N

**Reducing nipple, conical male thread, parallel female thread**

Art. No.	Type No.	Male thread F	Female thread F1	Ch mm	P mm	P1 mm	L mm
111340	235.01/N	R 1/4	G 1/8	14	11.0	7.0	16.0
111341	235.02/N	R 3/8	G 1/8	17	11.5	7.0	17.0
111342	235.03/N	R 3/8	G 1/4	17	11.5	8.0	17.0
111343	235.04/N	R 1/2	G 1/8	22	14.0	8.0	19.5
111344	235.05/N	R 1/2	G 1/4	22	14.0	8.0	20.0
111345	235.06/N	R 1/2	G 3/8	22	14.0	10.0	20.0
111346	235.07/N	R 3/4	G 3/8	27	16.5	11.5	23.0
111347	235.08/N	R 3/4	G 1/2	27	16.5	14.0	23.0
111348	235.09/N	R 1	G 1/2	34	16.0	15.0	25.0
111349	235.10/N	R 1	G 3/4	34	18.0	15.0	25.0

## Double nipple, parallel male thread

Art. No.	Type No.	Thread 1 F	Thread 2 F1	Ch mm	P mm	P1 mm	L mm
111350	252.31	M5	M5	8	4.0	4.0	11.5
111350 = discontinued product. No longer available. New product 134776 (MSN252M55)							
111351	252.32	M5	G 1/8	14	4.0	6.0	14.5
111351 = discontinued product. No longer available. New product 134777 (MSN252M518)							
111352	252.33	G 1/8	G 1/8	14	6.0	6.0	17.0
111352 = discontinued product. No longer available. New product 131891 (MSN2521818)							
111353	252.34	G 1/8	G 1/4	17	6.0	8.0	19.0
111353 = discontinued product. No longer available. New product 131892 (MSN2521814)							
111354	252.35	G 1/8	G 3/8	20	6.0	9.0	20.0
111354 = discontinued product. No longer available. New product 131893 (MSN2521838)							
100770	252.61	G 1/4	G 1/4	17	8.0	8.0	21.0
100770 = discontinued product. No longer available. New product 131894 (MSN2521414)							
111355	252.62	G 1/4	G 3/8	20	8.0	9.0	22.0
111355 = discontinued product. No longer available. New product 131895 (MSN2521438)							
111356	252.63	G 1/4	G 1/2	25	8.0	10.0	24.0
111356 = discontinued product. No longer available. New product 131896 (MSN2521412)							
100834	252.64	G 3/8	G 3/8	20	9.0	9.0	24.0
100834 = discontinued product. No longer available. New product 131897 (MSN2523838)							
111357	252.65	G 3/8	G 1/2	25	9.0	10.0	25.5
111357 = discontinued product. No longer available. New product 131898 (MSN2523812)							
111358	252.65-1	G 3/8	G 3/4	27	9.0	12.0	27.0
111358 = discontinued product. No longer available. New product 131899 (MSN2523834)							
100838	252.66	G 1/2	G 1/2	25	10.0	10.0	26.5
100838 = discontinued product. No longer available. New product 131900 (MSN2521212)							
111359	252.67	G 1/2	G 3/4	30	10.0	11.0	27.5
111359 = discontinued product. No longer available. New product 131901 (MSN2521234)							
111360	252.67-1	G 1/2	G 1	34	10.5	15.0	32.5
111360 = discontinued product. No longer available. New product 131902 (MSN252121)							
111361	252.68	G 3/4	G 1	36	12.0	11.0	30.0
111361 = discontinued product. No longer available. New product 131903 (MSN252341)							
111362	252.69	G 3/4	G 3/4	30	11.0	11.0	28.0
111362 = discontinued product. No longer available. New product 131904 (MSN2523434)							
111363	252.70	G 1	G 1	36	12.0	12.0	31.0
111363 = discontinued product. No longer available. New product 131905 (MSN25211)							
111364	252.71	G 1	G 1 1/4	43	15.0	16.0	38.0
111365	252.71-1	G 1	G 1 1/2	50	15.0	16.0	38.5
111366	252.71-2	G 1	G 2	60	15.0	18.0	42.0
111367	252.72	G 1 1/4	G 1 1/4	42	16.0	16.0	39.0
111368	252.72-1	G 1 1/4	G 1 1/2	50	16.0	16.0	40.0
111369	252.72-2	G 1 1/4	G 2	60	16.0	18.0	43.0
111370	252.73	G 1 1/2	G 1 1/2	50	16.0	16.0	39.5
111371	252.73-1	G 1 1/2	G 2	60	17.5	18.0	44.5
111372	252.74	G 2	G 2	60	17.5	17.5	44.0
111373	252.74-1	G 2	G 2 1/2	77	19.0	24.0	54.0
111374	252.74-2	G 2	G 3	89	20.0	20.0	50.0
111375	252.74-3	G 2 1/2	G 2 1/2	77	24.0	24.0	59.0
111375 = discontinued product. No longer available. New product 131917 (MSN252212212)							

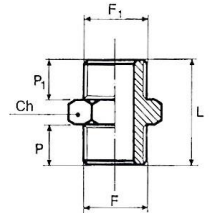

252.62

**P 6-337\_e**

## Standard screw fittings

Nickel-plated brass  
Art. No. 111330 to 111555



111376	252.74-4	G 2 1/2	G 3	89	22.5	20.0	52.5
111377	252.74-5	G 3	G 3	89	24.5	24.5	60.0

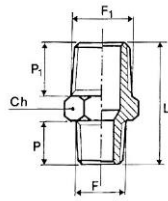

1252.66

## Double nipple, conical male thread

Art. No.	Type No.	Thread 1 F	Thread 2 F1	Ch mm	P mm	P1 mm	L mm
111378	1252.33	R 1/8	R 1/8	12	8.0	8.0	21.0
111378 = discontinued product. No longer available. New product 134782 (MSN252R1818)							
111379	1252.34	R 1/8	R 1/4	14	8.0	11.0	24.0
111379 = discontinued product. No longer available. New product 134783 (MSN252R1814)							
111380	1252.35	R 1/8	R 3/8	17	8.0	11.5	25.0
111380 = discontinued product. No longer available. New product 134784 (MSN252R1838)							
111381	1252.61	R 1/4	R 1/4	14	11.0	11.0	27.0
111381 = discontinued product. No longer available. New product 134785 (MSN252R1414)							
111382	1252.62	R 1/4	R 3/8	17	11.0	11.5	28.0
111382 = discontinued product. No longer available. New product 134786 (MSN252R1438)							
111383	1252.63	R 1/4	R 1/2	22	11.0	14.0	32.0
111383 = discontinued product. No longer available. New product 134787 (MSN252R1412)							
111384	1252.64	R 3/8	R 3/8	17	11.5	11.5	29.0
111384 = discontinued product. No longer available. New product 134788 (MSN252R3838)							
111385	1252.65	R 3/8	R 1/2	22	11.5	14.0	32.5
111386	1252.66	R 1/2	R 1/2	22	14.0	14.0	35.0
111386 = discontinued product. No longer available. New product 134792 (MSN252R1212)							
111387	1252.67	R 1/2	R 3/4	27	14.0	16.5	37.0
111388	1252.69	R 3/4	R 3/4	27	16.5	16.5	40.0
111388 = discontinued product. No longer available. New product 134795 (MSN252R3434)							
111389	1252.68	R 3/4	R 1	34	16.5	19.0	42.5
111390	1252.70	R 1	R 1	34	19.0	19.0	45.5
111390 = discontinued product. No longer available. New product 134797 (MSN252R11)							

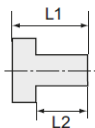

252.92-N

## Hexagon socket screw plug with collar

Art. No.	Type No.	Thread	L1 mm	L2 mm	a/f mm
111391	252.91-N	G 1/8	11,0	8,0	5
111391 = discontinued product. No longer available. New product 137910 (MSN290MS18)					
111392	252.92-N	G 1/4	13,0	10,0	6
111392 = discontinued product. No longer available. New product 137911 (MSN290MS14)					
111393	252.93-N	G 3/8	15,0	12,0	8
111393 = discontinued product. No longer available. New product 137912 (MSN290MS38)					
111394	252.94-N	G 1/2	18,0	14,0	10
111394 = discontinued product. No longer available. New product 137913 (MSN290MS12)					
111395	252.94-2N	G 3/4	24,0	20,0	12
111396	252.94-3N	G1	27,0	22,0	17

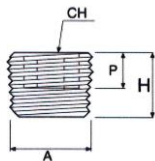

253.101

## Hexagon socket screw plug without collar

Art. No.	Type No.	Thread A	H mm	P mm	Ch mm
111397	253.101-N	R 1/8	8.0	4,0	5
111397 = discontinued product. No longer available. New product 137938 (MSN290ROB18)					
111398	253.102-N	R 1/4	10.0	5,0	6
111398 = discontinued product. No longer available. New product 137939 (MSN290ROB14)					
111399	253.103-N	R 3/8	10.0	6,0	8
111399 = discontinued product. No longer available. New product 137940 (MSN290ROB38)					
111400	253.104-N	R 1/2	12.0	8,0	10
111400 = discontinued product. No longer available. New product 137941 (MSN290ROB12)					

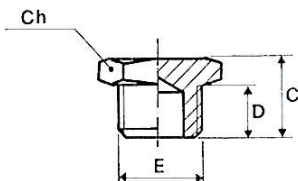

252.96/N

## Hexagon head screw plug

Art. No.	Type No.	Thread E	C mm	D mm	Ch mm
111401	252.90/N	M5	7.0	4.0	8
111401 = discontinued product. No longer available. New product 137947 (MSN290SKM5)					
111402	252.95/N	G 1/8	10.0	6.0	14
111402 = discontinued product. No longer available. New product 137948 (MSN290SK18)					
111403	252.96/N	G 1/4	12.5	8.0	17
111403 = discontinued product. No longer available. New product 137949 (MSN290SK14)					
111404	252.97/N	G 3/8	13.5	9.0	19
111404 = discontinued product. No longer available. New product 137950 (MSN290SK38)					
111405	252.98/N	G 1/2	15.5	10.0	24
111405 = discontinued product. No longer available. New product 137951 (MSN290SK12)					
111406	252.99/N	G 3/4	16.5	11.0	30
111406 = discontinued product. No longer available. New product 137952 (MSN290SK34)					
111407	252.100/N	G 1	19.0	13.0	38
111407 = discontinued product. No longer available. New product 137953 (MSN290SK1)					

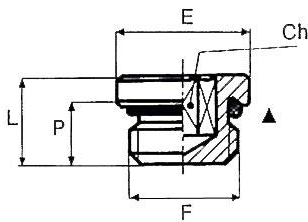

233.05-N

## Hexagon socket screw plug with NBR O-ring

Art. No.	Type No.	Thread F	Hexagon socket head Ch mm	P mm	L mm	E mm	O-Ring mm	Max. locking torque Nm
111408	233.01-N	M5	2.5	4.0	6.5	8.0	3.5x1.2	1.2
111409	233.02-N	G 1/8	3	7.0	9.5	15.0	7.66x1.78	2.5
111410	233.03-N	G 1/4	6	8.0	11.0	18.0	10.82x1.78	8
111411	233.04-N	G 3/8	8	9.0	12.5	21.0	14.00x1.78	10
111412	233.05-N	G 1/2	10	11.0	14.5	26.0	17.13x2.62	15
111413	233.06-N	G 3/4	17	11.1	15.5	34.0	-	-
111414	233.07-N	G 1	19	11.8	16.0	38.0	-	-

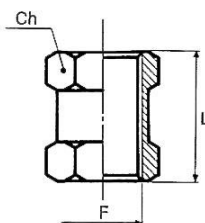

252.23/N

## Socket with outer hex

Art. No.	Type No.	Thread F	Ch mm	L mm
111415	252.20/N	M5	8	11.0
111415 = discontinued product. No longer available. New product 138460 (MSN252MUM5)				
111416	252.21/N	G 1/8	14	15.0
111416 = discontinued product. No longer available. New product 138461 (MSN252MU18)				
111417	252.22/N	G 1/4	17	22.0
111417 = discontinued product. No longer available. New product 138462 (MSN252MU14)				
111418	252.23/N	G 3/8	22	24.0
111418 = discontinued product. No longer available. New product 138463 (MSN252MU38)				
111419	252.24/N	G 1/2	27	30.0
111419 = discontinued product. No longer available. New product 138464 (MSN252MU12)				
111420	252.24/1-N	G 3/4	32	32.0
111420 = discontinued product. No longer available. New product 138465 (MSN252MU34)				
111421	252.25/N	G 1	38	35.0
111421 = discontinued product. No longer available. New product 138466 (MSN252MU1)				

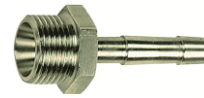
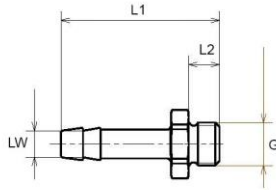

N239 E-N1

**Male hose fitting, parallel male thread**

Art. No.	Type No.	Thread G	for hose mm	L1 mm	L2 mm	a/f mm
111422	N239.02-N	G 1/8	I.D. 6	36.0	7.0	14
111422 = discontinued product. No longer available. New product 131040 (MSN2391806)						
111423	N239.02-N1	G 1/8	I.D. 8	36.0	7.0	14
111424	N239.03-N	G 1/4	I.D. 9	36.0	7.0	14
111425	N239 A-N	G 1/4	I.D. 4	36.0	9.0	17
111426	N239 B-N	G 1/4	I.D. 6	36.0	9.0	17
111427	N239 B-N1	G 1/4	I.D. 8	39.0	9.0	17
111427 = discontinued product. No longer available. New product 131045 (MSN2391408)						
111428	N239 C-N	G 1/4	I.D. 9	39.0	9.0	17
111428 = discontinued product. No longer available. New product 131046 (MSN2391409)						
111429	N239 C-N1	G 1/4	I.D. 10	39.0	9.0	17
111429 = discontinued product. No longer available. New product 131047 (MSN2391410)						
111430	N239 CS-N	G 1/4	I.D. 13	39.0	9.0	17
111431	N239 E-N1	G 3/8	I.D. 8	42.0	9.0	17
111432	N239 F-N	G 3/8	I.D. 9	39.0	9.0	19
111433	N239 F-N1	G 3/8	I.D. 10	39.0	9.0	19
111434	N239 FS-N	G 3/8	I.D. 13	42.0	9.0	19
111434 = discontinued product. No longer available. New product 131056 (MSN2393813)						
111435	N239 G-N1	G 1/2	I.D. 8	42.0	9.0	19
111435 = discontinued product. No longer available. New product 131058 (MSN2391208)						
111436	N239 H-N	G 1/2	I.D. 9	42.0	11.0	24
111436 = discontinued product. No longer available. New product 131059 (MSN2391209)						
111437	N239 H-N1	G 1/2	I.D. 10	42.0	11.0	24
111437 = discontinued product. No longer available. New product 131060 (MSN2391210)						
111438	N239 J-N	G 1/2	I.D. 13	45.0	11.0	24
111438 = discontinued product. No longer available. New product 131061 (MSN2391213)						
111439	N239 J-N1	G 1/2	I.D. 16	53.0	11.0	24
111440	N239 J-N2	G 1/2	I.D. 19	53.0	11.0	24
111440 = discontinued product. No longer available. New product 131063 (MSN2391219)						
111441	N239 M-N	G 3/4	I.D. 13	51.0	12.0	24
111441 = discontinued product. No longer available. New product 131065 (MSN2393413)						
111442	N239 N-N	G 3/4	I.D. 16	51.0	12.0	32
111442 = discontinued product. No longer available.						
111443	N239 P-N	G 3/4	I.D. 19	54.0	12.0	32
111443 = discontinued product. No longer available. New product 131067 (MSN2393419)						
111444	N239 R-N	G 3/4	I.D. 25	54.0	12.0	32
111445	N239 W-N	G 1	I.D. 25	55.0	13.0	38
111445 = discontinued product. No longer available. New product 131072 (MSN239125)						
111446	N239 Z-N	G 1	I.D. 32	55.0	13.0	38



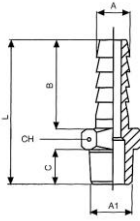

239.107

**Male hose fitting**, conical male thread acc. to ISO 7-1

Art. No.	Type No.	A mm	Thread A1	B mm	C mm	L mm	CH mm
111447	239.101	I.D. 6	R 1/8	19.0	8.0	31.5	12
111447 = discontinued product. No longer available. New product 134185 (MSN239R1806)							
111448	239.102	I.D. 8	R 1/8	19.0	8.0	31.5	12
111448 = discontinued product. No longer available. New product 134186 (MSN239R1808)							
111449	239.103	I.D. 9	R 1/8	19.0	8.0	31.5	12
111449 = discontinued product. No longer available. New product 134187 (MSN239R1809)							
111450	239.104	I.D. 10	R 1/8	20.0	8.0	32.5	12
111450 = discontinued product. No longer available. New product 134188 (MSN239R1810)							
111451	239.105	I.D. 6	R 1/4	19.0	11.0	35.0	14
111451 = discontinued product. No longer available. New product 134190 (MSN239R1406)							
111452	239.106	I.D. 8	R 1/4	19.0	11.0	35.0	14
111452 = discontinued product. No longer available. New product 134191 (MSN239R1408)							
111453	239.107	I.D. 9	R 1/4	19.0	11.0	35.0	14
111453 = discontinued product. No longer available. New product 134192 (MSN239R1409)							
111454	239.108	I.D. 10	R 1/4	20.0	11.0	36.0	14
111454 = discontinued product. No longer available. New product 134193 (MSN239R1410)							
111455	239.109	I.D. 12	R 1/4	20.0	11.0	36.0	14
111455 = discontinued product. No longer available. New product 134194 (MSN239R1412)							
111456	N239.109-1	I.D. 13	R 1/4	-	11.0	39.5	14
111457	239.110	I.D. 9	R 3/8	19.0	11.5	35.5	17
111457 = discontinued product. No longer available. New product 134199 (MSN252R3809)							
111458	239.111	I.D.10	R 3/8	20.0	11.5	36.5	17
111458 = discontinued product. No longer available. New product 134200 (MSN252R3810)							
111459	239.112	I.D. 12	R 3/8	20.0	11.5	36.5	17
111459 = discontinued product. No longer available. New product 134201 (MSN239R3812)							
111460	N239.112-1	I.D. 13	R 3/8	-	11.5	41.0	17
111461	239.113	I.D. 9	R 1/2	19.0	14.0	38.5	22
111461 = discontinued product. No longer available. New product 134205 (MSN239R1209)							
111462	239.114	I.D. 10	R 1/2	20.0	14.0	39.5	22
111462 = discontinued product. No longer available. New product 134206 (MSN239R1210)							
111463	239.115	I.D. 12	R 1/2	20.0	14.0	39.5	22
111463 = discontinued product. No longer available. New product 134207 (MSN239R1212)							
111464	N239.116	I.D. 13	R 1/2	-	15.0	44.5	22
111464 = discontinued product. No longer available. New product 134208 (MSN239R1213)							
111465	N239.117	I.D. 16	R 1/2	-	15.0	44.5	22
111465 = discontinued product. No longer available. New product 134209 (MSN239R1216)							
111466	N139.118	I.D. 19	R 1/2	-	15.0	44.5	22
111466 = discontinued product. No longer available. New product 134210 (MSN239R1219)							

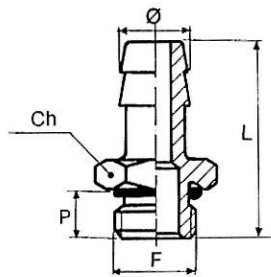

239.515

## Male hose fitting, parallel, with O-ring

Art. No.	Type No.	For hose Ø mm	Thread F	Ch mm	P mm	L mm	O-ring mm
111467	239.501	I.D. 5	G 1/8	14	6,5	30,0	7,66x1,78
111468	239.502	I.D. 7	G 1/8	15	6,0	31,0	7,66x1,78
111469	239.503	I.D. 8	G 1/8	15	6,0	31,0	7,66x1,78
111470	239.505	I.D. 5	G 1/4	17	8,0	32,0	10,82x1,78
111471	N239.506-N	I.D. 7	G 1/4	17	8,0	32,0	10,82x1,78
111472	239.507	I.D. 8	G 1/4	18	8,0	33,0	10,82x1,78
111473	N239.508-N	I.D. 9	G 1/4	17	8,0	33,0	10,82x1,78
111474	239.509	I.D. 11	G 1/4	18	8,0	33,0	10,82x1,78
111475	N239.520-N	I.D. 12	G 1/4	18	8,0	33,0	10,82x1,78
111476	N239.521-N	I.D. 5	G 3/8	20	9,0	33,0	14,00x1,78
111477	N239.522-N	I.D. 7	G 3/8	20	9,0	33,0	14,00x1,78
111478	239.510	I.D. 8	G 3/8	21	9,0	34,0	14,00x1,78
111479	N239.511-N	I.D. 9	G 3/8	20	9,0	34,0	14,00x1,78
111480	239.512	I.D. 11	G 3/8	21	9,0	34,0	14,00x1,78
111481	N239.513-N	I.D. 12	G 3/8	20	9,0	34,0	14,00x1,78
111482	239.515	I.D. 11	G 1/2	26	11,0	36,0	17,13x2,62
111483	N239.516-N	I.D. 12	G 1/2	24	10,0	36,0	17,13x2,62
111484	N239.517-N	I.D. 15	G 1/2	25	10,0	40,0	17,13x2,62
111485	N239.518-N	I.D. 18	G 1/2	24	10,0	40,0	17,13x2,62
117810	239.1213.MSN.OR	I.D. 13	G 1/2	25	10,0	40,0	17,13x2,62
117830	239.3813.MSN.OR	I.D. 13	G 3/8	20	9,0	38,0	14,00x1,78
117849	239.3815.MSN.OR	I.D. 15	G 3/8	20	9,0	38,0	14,00x1,78
117859	239.1216.MSN.OR	I.D. 16	G 1/2	26	11,0	36,0	17,13x2,62
117870	239.3816.MSN.OR	I.D. 16	G 3/8	21	9,0	34,0	14,00x1,78
117877	239.1219.MSN.OR	I.D. 19	G 1/2	25	10,0	40,0	17,13x2,62

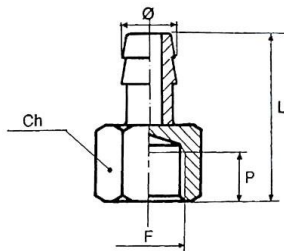

237.09-N

## Female stem with parallel female thread

Art. No.	Type No.	For hose Ø mm	Thread F	Ch mm	P mm	L mm
111486	237.01-N	I.D. 6	G 1/8	12	8.5	28.0
111486 = discontinued product. No longer available. New product 134877 (MSN239A1806)						
111487	237.02-N	I.D. 8	G 1/8	12	8.5	28.0
111487 = discontinued product. No longer available. New product 134878 (MSN239A1808)						
111488	237.03-N	I.D. 9	G 1/8	12	8.5	28.0
111488 = discontinued product. No longer available. New product 134879 (MSN239A1809)						
111489	237.04-N	I.D. 10	G 1/8	12	8.5	28.0
111490	237.05-N	I.D. 6	G 1/4	15	10.0	33.0
111490 = discontinued product. No longer available. New product 134882 (MSN239A1406)						
111491	237.06-N	I.D. 8	G 1/4	15	10.0	33.0
111491 = discontinued product. No longer available. New product 134883 (MSN239A1408)						
111492	237.07-N	I.D. 9	G 1/4	15	10.0	33.0
111492 = discontinued product. No longer available. New product 134884 (MSN239A1409)						
111493	237.08-N	I.D. 10	G 1/4	15	10.0	33.0
111493 = discontinued product. No longer available. New product 134885 (MSN239A1410)						
111494	237.09-N	I.D. 12	G 1/4	15	10.0	33.0
111495	237.10-N	I.D. 8	G 3/8	19	12.0	35.0
111495 = discontinued product. No longer available. New product 134890 (MSN239A3808)						
111496	237.11-N	I.D. 10	G 3/8	19	12.0	35.0
111497	237.12-N	I.D. 12	G 3/8	19	12.0	35.0
111498	237.13-N	I.D. 14	G 3/8	19	12.0	35.0
111499	237.14-N	I.D.10	G 1/2	25	14.0	38.0
111499 = discontinued product. No longer available. New product 134899 (MSN239A1210)						
111500	237.15-N	I.D. 12	G 1/2	25	14.0	41.0
111500 = discontinued product. No longer available. New product 134900 (MSN239A1212)						
111501	237.16-N	I.D. 14	G 1/2	25	14.0	41.0

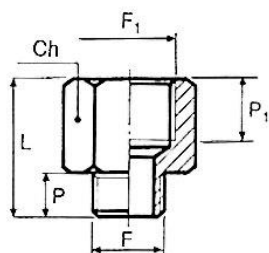

230.08-N

**Extension, short, parallel**

Art. No.	Type No.	Male thread F	Female thread F1	Ch mm	P mm	P1 mm	L mm
111502	230.01-N	M5	G 1/8	12	4.0	7.0	17.0
111503	230.02-N	G 1/8	G 1/8	14	6.0	7.0	18.5
111504	230.03-N	G 1/8	G 1/4	17	6.0	8.0	21.5
111505	230.04-N	G 1/4	G 1/4	17	8.0	8.0	22.5
111506	230.05-N	G 1/4	G 3/8	22	8.0	10.0	26.0
111507	230.06-N	G 3/8	G 3/8	22	9.0	10.0	26.5
111508	230.07-N	G 3/8	G 1/2	24	9.0	11.0	29.5
111509	230.08-N	G 1/2	G 1/2	25	10.0	11.0	29.5

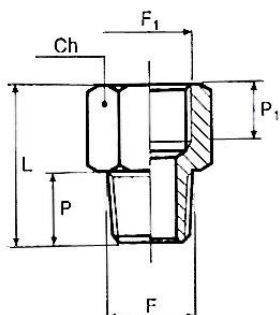

1230.10-N

**Extension, short, conical male thread, parallel female thread**

Art. No.	Type No.	Male thread F	Female thread F1	Ch mm	P mm	P1 mm	L mm
111510	1230.02-N	R 1/8	G 1/8	14	8.0	7.0	20.0
111511	1230.03-N	R 1/8	G 1/4	17	8.0	8.0	22.5
111512	1230.09-N	R 1/8	G 3/8	22	8.0	11.5	21.5
111513	1230.04-N	R 1/4	G 1/4	17	11.0	8.0	25.0
111514	1230.05-N	R 1/4	G 3/8	22	11.0	10.0	28.5
111515	1230.06-N	R 1/4	G 1/2	24	11.0	14.0	29.0
111516	1230.07-N	R 3/8	G 3/8	22	11.5	10.0	28.5
111517	1230.08-N	R 3/8	G 1/2	24	11.5	11.0	32.0
111518	1230.10-N	R 1/2	G 1/2	24	14.0	11.0	34.0
111519	1230.11-N	R 1/2	G 3/4	32	14.0	16.5	35.0

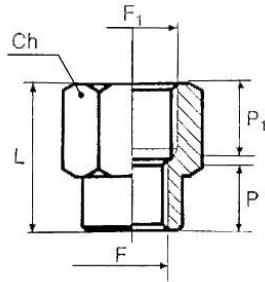

231.07-N

### Extensions, 2 x female thread, parallel

Art. No.	Type No.	Thread 1 F	Thread 2 F1	Ch mm	P mm	P1 mm	L mm
111520	231.01-N	M5	G 1/8	14	5.0	8.0	13.5
111521	231.02-N	G 1/8	G 1/4	17	8.0	8.0	21.5
111522	231.03-N	G 1/8	G 3/8	22	7.0	10.0	23.5
111523	231.04-N	G 1/4	G 3/8	22	9.0	10.0	25.5
111524	231.05-N	G 1/4	G 1/2	24	9.0	11.0	28.5
111525	231.06-N	G 3/8	G 1/2	24	11.0	11.0	29.5
111526	231.07-N	G 1/2	G 3/4	32	11.5	16.5	30.0
111527	231.08-N	G 1/2	G 1/8	24	-	-	24,0
111528	231.09-N	G 1	G 3/4	38	-	-	25,0

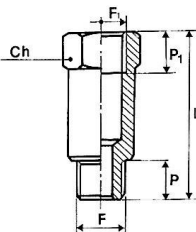

234.07-N

### Extension, long, parallel

Art. No.	Type No.	Male thread F	Female thread F1	Ch mm	P mm	L mm	P1 mm
111529	234.01-N	G 1/8	G 1/8	14	6.0	22.0	8.0
111530	234.02-N	G 1/8	G 1/8	14	6.0	42.0	8.0
111531	234.03-N	G 1/8	G 1/8	14	6.0	51.0	6.0
111532	234.04-N	G 1/8	G 1/8	14	6.0	100.0	8.0
111533	234.05-N	G 1/4	G 1/4	17	8.0	35.0	11.0
111534	234.06-N	G 1/4	G 1/4	17	8.0	51.0	11.0
111535	234.07-N	G 1/4	G 1/4	17	8.0	100.0	11.0

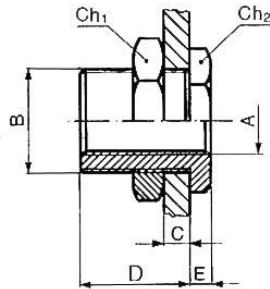

232.04-N

## Bulkhead connector

Art. No.	Type No.	Female thread A	Male thread B	Max. operating temperature °C	C <sub>max</sub>	D mm	E mm	Ch1 mm	Ch2 mm
111536	232.01-N	G 1/8	M16x1.5	150	0	14.0	4.0	19	22
111536 = discontinued product. No longer available. New product 138492 (MSN232M1618)									
111537	232.02-N	G 1/4	M20x1.5	150	0	21.0	5.0	27	24
111537 = discontinued product. No longer available. New product 138493 (MSN232M2014)									
111538	232.03-N	G 3/8	M26x1.5	150	0	21.0	5.0	30	32
111538 = discontinued product. No longer available. New product 138494 (MSN232M2638)									
111539	232.04-N	G 1/2	M28x1.5	150	0	27.0	6.5	36	32
111539 = discontinued product. No longer available. New product 138495 (MSN232M2812)									

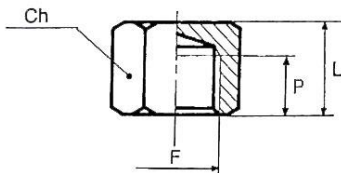

236.04-N

## Cap

Art. No.	Type No.	Thread F	Ch mm	P mm	L mm
111540	236.01-N	G 1/8	14	7.0	13.0
111541	236.02-N	G 1/4	17	8.0	15.0
111541 = discontinued product. No longer available. New product 138497 (MSNVK14)					
111542	236.03-N	G 3/8	20	10.0	17.5
111543	236.04-N	G 1/2	24	11.0	20.0
111543 = discontinued product. No longer available. New product 138499 (MSNVK12)					
111544	236.05-N	G 3/4	30	-	14.0
111545	236.06-N	G 1	37	-	15.0

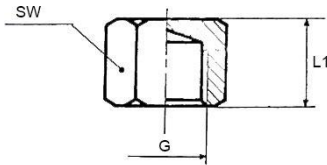

239.03-N

**Hexagonal swivel nut**

Art. No.	Type No.	Thread G	for fitting size	L1 mm	a/f mm
111546	239.01-N	G 1/8	LW 4, LW 6	13.0	14
111547	239.02-N	G 1/4	LW 4, LW 6	15.0	17
111548	239.03-N	G 3/8	LW 4	15.0	19
111549	239.04-N	G 1/2	LW 4, LW 6, LW 9	16.0	24

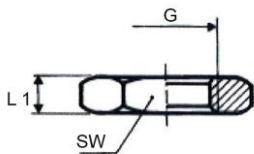

238.03

**Lock nuts**

Art. No.	Type No.	Thread G	L1 mm	SW mm
111550	238.01-N	G 1/8	4.5	14
111550 = discontinued product. No longer available. New product 138502 (MSN23818)				
111551	238.02-N	G 1/4	5.0	17
111551 = discontinued product. No longer available. New product 138503 (MSN23814)				
111552	238.03-N	G 3/8	5.5	19
111552 = discontinued product. No longer available. New product 138504 (MSN23838)				
111553	238.04-N	G 1/2	6.0	24
111554	238.05-N	G 3/4	6.0	30
111554 = discontinued product. No longer available. New product 138506 (MSN23834)				
111555	238.06-N	G 1	8.0	38